

## THE PRACTICE SESSION

We recommend that you follow the practice session before attempting to use your SOMACorrect System for Peyronie's Disease Management. The practice session gives your tissues time to get used to being stretched to full size in a Vacuum Erection System.

The practice session should be conducted for 10 to 20 minutes per day for one week.

During the practice session you will not use the the smaller cylinder inserts - use only the outer C size.

Should you need additional information please refer the Instruction Manual that is included with your SOMACorrect \* system.

Additional instruction can be obtained by calling our Customer Service department at 01923 23 77 95 Monday to Friday 9am to 6pm

## THE COMPONENTS OF YOUR SYSTEM

1. Negative Pressure Cylinder
2. Negative Pressure Device
3. Comfort Inserts
4. A and B Cylinder Inserts
5. SomaTherapy-ED® Lubricant

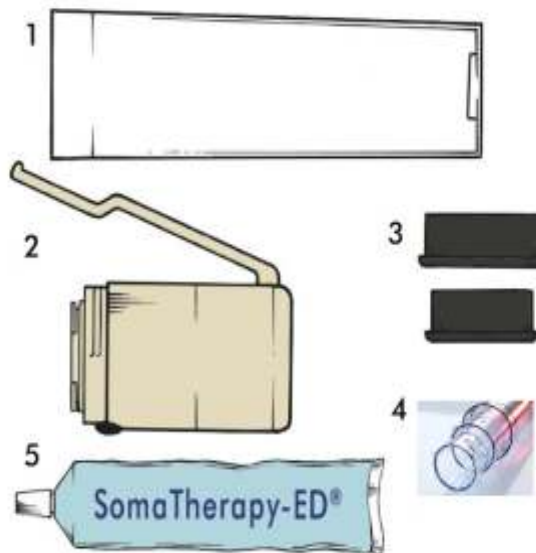

## STEP 1: ASSEMBLE YOUR SYSTEM

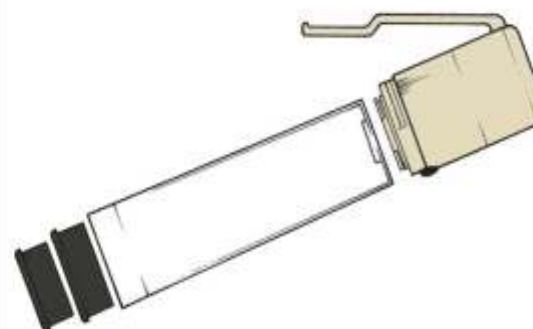

Assemble your system by lining up the negative pressure device with the negative pressure cylinder. Give the negative pressure device 1/4 turn to secure it to the negative pressure cylinder. **Caution: Do Not Over Tighten.** Insert the large comfort insert into the base of the cylinder. If necessary, insert the small comfort insert into the large comfort insert.

## STEP 2: LUBRICATION PROCESS



## STEP 3: THE APPLICATION PROCESS



Apply the system over the penis with the system pointed down towards the floor at a 45 degree angle. Make sure that the penis is resting at the bottom of the cylinder. Give the system a twist back and forth to ensure that a good seal is created against the body. **Do not press the cylinder too hard against the body.**



Begin operating the negative pressure device by pumping the handle 3 times. Wait 10 seconds to allow blood to flow into the penis. Continue this start and stop process until the penis has reached full engorgement and the penis has lifted from the bottom of the cylinder. Be careful not to create negative pressure too quickly or over pump.

## STEP 4: TERMINATE THE ERECTION

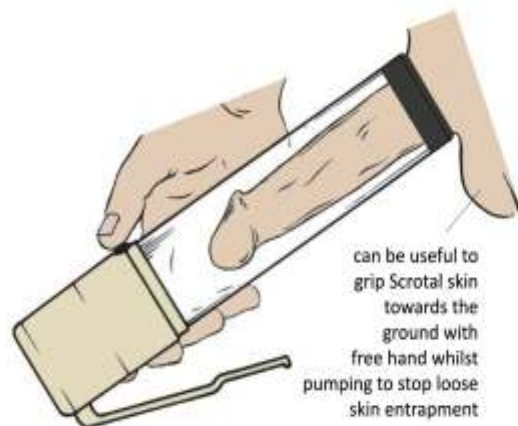

can be useful to grip Scrotal skin towards the ground with free hand whilst pumping to stop loose skin entrapment

Hold the erection for 5 seconds. To terminate the erection, push the round, black pressure release valve to remove negative pressure. Repeat this process for 10-20 minutes each day.

Continue this practice session daily for at least 1 week before moving to the application process for Peyronie's Disease Management.

## SOMACorrect PD® Patient Quick Start Guide

We recommend that you read and view the enclosed Instruction Manual and Instructional Video before attempting to use your new SOMACorrect \* Vacuum Therapy System.

This guide has been developed as a reference guide only and does not replace your Instruction Guide or any instruction you may have received from your physician.

For more information  
Call iMEDicare  
(UK and ROI Distributor)

**+441923 23 77 95**

Monday to Friday 9am to 6pm

Unit 11 Shakespeare Ind. Est.

Shakespeare Str., Watford WD24 5RR

contact@imedicare.co.uk

www.iMEDicare.co.uk

Do not use if you suffer from any active uncontrolled blood coagulation disorder (such as polycythaemia, haemophilia, leukaemia etc) that can cause excessive bleeding or clotting. Do not use if you are taking blood thinning agents AND your INR is NOT stable – ie clotting time is abnormal. Do not use if under the influence of alcohol or mind altering substances.

SomaTherapy ED® 2007-MDD/CE041				
<b>EC REP</b>		CEpartner4U, Esdoornlaan 13 3951 DB Maarn, The Netherlands Office: +31.343.442.524 Cell: +31.6.516.536.26 <a href="http://www.cepartner4u.com">www.cepartner4u.com</a> , <a href="mailto:office@cepartner4u.com">office@cepartner4u.com</a>		
		<b>Manufacturer:</b> Augusta Medical Systems LLC, 1027 Broad St, Augusta, GA 30901, United States. Tel 001(706) 821-3600 <a href="http://www.augustams.com">www.augustams.com</a>		
<b>REF</b>		SOMACorrect (15080)		
<b>LOT</b>		2015		